

Dimensions

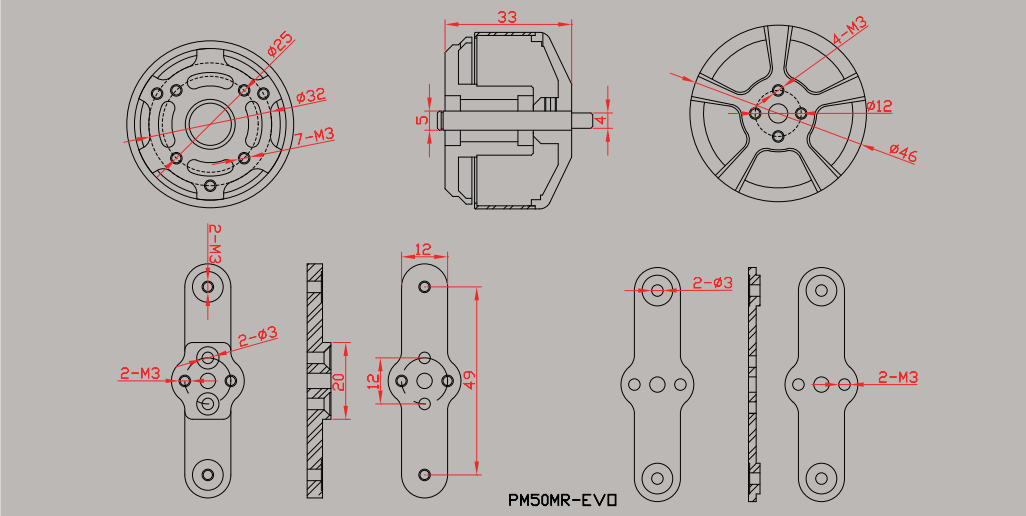

Specification

Xmotor Multi-Rotor		XM4614MR 9 TURN
RPM/V(KV值)	(KV)	380
Weight w/o wires(重量)	(g)	145
Diameter(直径)	(mm)	46
Length(长度)	(mm)	33
Diameter of Shaft(轴径)	(mm)	4.0, 5.0
Mounting holes pitch(安装孔距)	(mm)	25/25
Slots,Poles(极数)		24N22P
Idle Current(空载电流)	(Io) @10V(A)	0.7
Resistance(内阻)	(Ri)(mOhm)	91
Cruising power(巡航功率)	(W)[8 mins]	338
Bursts current(最大电流)	(A)[15s]	28
Peak power(峰值功率)	(W)[15s]	614
Input wire(输入线)		18AWG, 600mm
Recommended ESC(推荐调速器)		XC-401-MR
Setup 1(配置1)	(No. of Cell, Prop.)	6S, 15x5 - 16x5
Weight of quad-copter(4轴重量)	(kg)	3.8
Weight of hex-copter(六轴重量)	(kg)	5.6

XM4614MR-9

